

CURVE 2D

ELBOWS BA 2

EN 10253-1 - DIN 2605/1 - ISO 3419

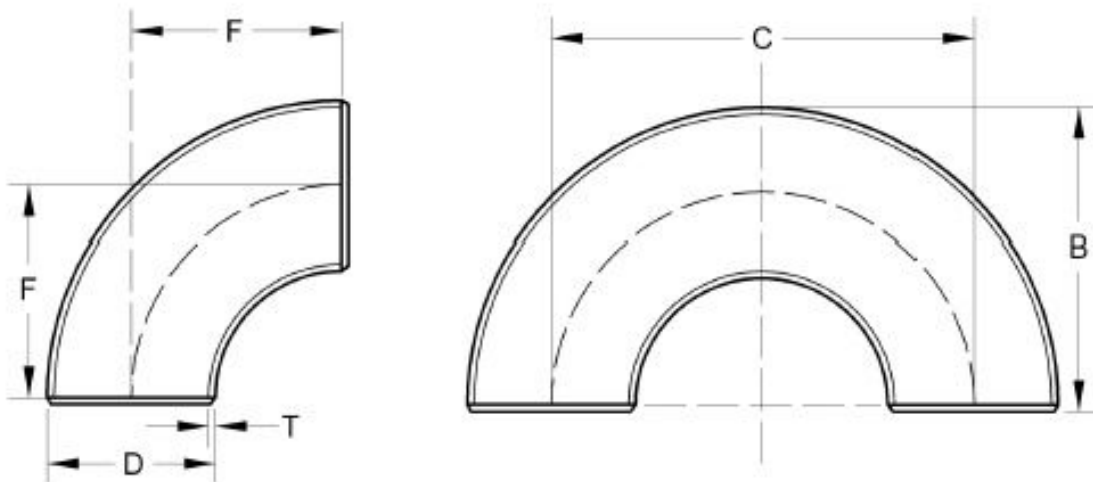

Dimensioni in mm.

D	T	F	C	B	Kg.	
					90°	180°
21.3	2.0	17.5	35	28	0.08	0.12
26.9	2.3	25	50	39	0.07	0.14
33.7	2.6	25	50	42	0.08	0.16
42.4	2.6	32	64	53	0.13	0.26
48.3	2.6	38	76	62	0.18	0.36
60.3	2.9				0.33	0.66
	4.5	51	102	81	0.50	1.00
	5.6				0.61	1.22
76.1	2.9	63	127	102	0.56	1.12
88.9	3.2				0.81	1.62
	5.6	76	152	121	1.38	2.76
101.6	3.6	95	190	146	1.22	2.44
108.0	3.6	100	200	154	1.46	2.92
114.3	3.6				1.58	3.16
	6.3	102	203	159	2.89	5.78
	8.8				3.67	7.34
139.7	4.0	127	254	197	2.67	5.34
168.3	4.5				4.34	8.68
	7.1	152	305	237	6.74	13.48
	11.0				10.20	20.40
219.1	6.3				10.50	21.00
	8.0	203	406	313	13.30	26.60
	12.5				20.30	40.60
273.0	6.3	254	508	391	15.50	31.00
323.9	7.1	305	610	467	28.60	57.20
355.6	8.0	356	711	533	30.50	61.00
406.4	8.8	406	813	610	55.00	110.00
457.2	10.0	457	914	686	80.00	160.00
508.0	11.0	508	1016	762	109.00	218.00
609.6	12.5	609	1219	914	175.00	350.00

Assotherm srl - Via Fratelli Calvi, 7 - 24060 Casazza (BG) Italy
 Tel +39 035813182 - Fax +39 035816892 - E-mail info@assotherm.com

TEES

EQUAL AND REDUCING TEES

EN 10253-1 - DIN 2615/1 - ISO 3419

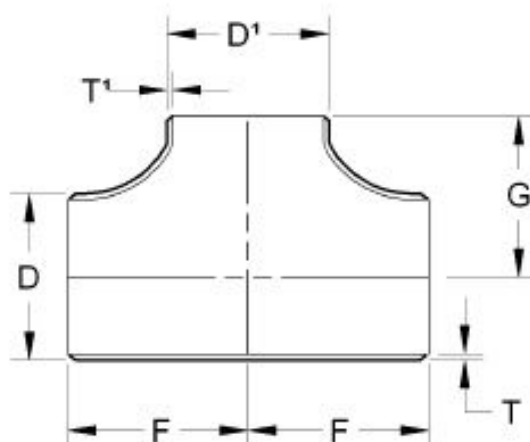
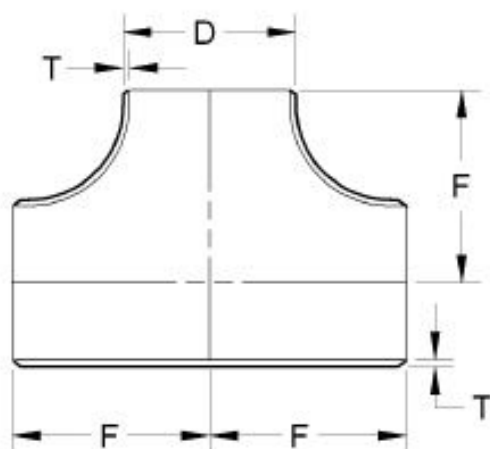

Dimensioni in mm.

D	D1	T	T1	F	G	Kg.	D	D1	T	T1	F	G	Kg.		
21.3	21.3	2.0	2.0	25	-	0.08	133.0	133.0	4.0	4.0	120	-	4.80		
26.9	26.9	2.3	2.3	29	-	0.12	139.7	139.7	4.0	4.0	124	-	5.10		
	21.3		2.0		29	29		0.12		114.3		3.6	117	5.10	
33.7	33.7	2.6	2.6	38	-	0.26	139.7	88.9	4.0	3.2	124	111	5.10		
	26.9		2.3		38	38		0.26		78.1		2.9	108	5.10	
	21.3		2.0		38	38		0.26		60.3		2.9	105	5.10	
42.4	42.4	2.6	2.6	48	-	0.45	159.0	159.0	4.5	4.5	138	-	8.10		
	33.7		2.6		48	48		0.45		168.3		4.5	-	9.00	
	26.9		2.3		48	48		0.45		139.7		4.0	137	9.00	
48.3	48.3	2.6	2.6	57	-	0.58	168.3	114.3	4.5	3.6	143	130	9.00		
	42.4		2.6		57	57		0.58		88.9		3.2	124	9.00	
	33.7		2.6		57	57		0.58		78.1		2.9	121	9.00	
	26.9		2.3		57	57		0.58		60.3		2.9	117	9.00	
	21.3		2.0		57	57		0.58		-		-	-	-	
60.3	60.3	2.9	2.9	64	-	0.85	219.1	219.1	6.3	6.3	178	-	18.00		
	48.3		2.6		60	60		0.85		168.3		4.5	168	18.00	
	42.4		2.6		64	57		0.85		139.7		4.0	162	18.00	
	33.7		2.6		51	51		0.85		114.3		3.6	156	18.00	
	26.9		2.3		44	44		0.85		88.9		3.2	152	18.00	
76.1	76.1	2.9	2.9	76	-	1.20	273.0	273.0	6.3	6.3	216	-	26.50		
	60.3		2.9		70	70		1.20		219.1		6.3	203	26.50	
	48.3		2.6		67	67		1.20		168.3		4.5	194	26.50	
	42.4		2.6		64	64		1.20		139.7		4.0	191	26.50	
	33.7		2.6		57	57		1.20		114.3		3.6	184	26.50	
88.9	88.9	3.2	3.2	86	-	1.80	323.9	323.9	7.1	7.1	254	-	42.00		
	76.1		2.9		83	83		1.80		273.0		6.3	241	42.00	
	60.3		2.9		76	76		1.80		219.1		6.3	229	42.00	
	48.3		2.6		73	73		1.80		168.3		4.5	219	42.00	
	42.4		2.6		70	70		1.80		-		-	-	-	
33.7	2.6	67	67	1.80	355.6	8.0	8.0	-	71.00						
101.6	101.6	3.6	3.6	95	-	2.90	355.6	323.9	8.0	7.1	279	270	60.00		
	108.0		3.6		100	100		3.10		273.0		6.3	257	60.00	
	114.3		3.6		-	-		3.10		219.1		6.3	248	54.00	
	88.9		3.2		98	98		3.10		168.3		4.5	238	54.00	
114.3	76.1	3.6	2.9	105	95	3.10	406.4	139.7	8.8	4.0	305	245	52.00		
	60.3		2.9		89	89		3.10		406.4		8.8	8.8	-	85.00
	48.3		2.6		86	86		3.10		355.6		8.0	8.0	305	85.00
	33.7		2.6		86	86		3.10		323.9		7.1	295	85.00	
							273.0		6.3		283	82.00			
							219.1		6.3		273	74.00			
							168.3		4.5		264	74.00			

Assotherm srl - Via Fratelli Calvi, 7 - 24060 Casazza (BG) Italy
 Tel +39 035813182 - Fax +39 035816892 - E-mail info@assotherm.com

RIDUZIONI

CONC. / ECC. REDUCERS

EN 10253-1 - DIN 2616/1/2 - ISO 3419

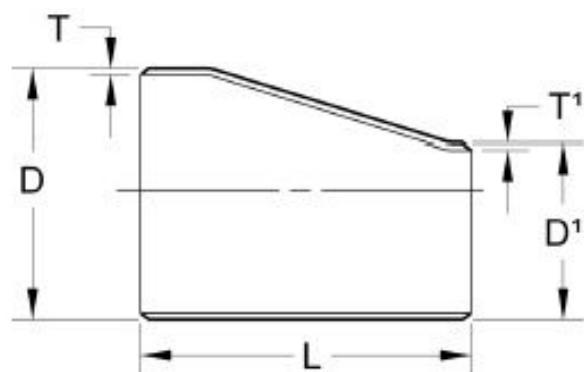
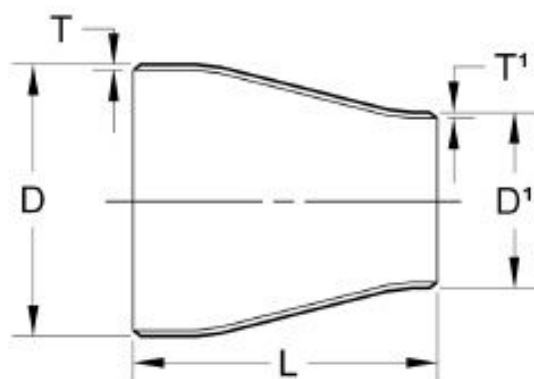

Dimensioni in mm.

D	D1	T	T1	L	Kg.	D	D1	T	T1	L	Kg.
26.9	21.3	2.3	2.0	38	0.05	108.0	88.9	3.6	3.2	100	0.90
33.7	26.9	2.6	2.3	51	0.10		76.1		2.9		0.90
	21.3		2.0		0.10		70.0		2.9		0.90
42.4	33.7	2.6	2.6	51	0.12		60.3		2.9		0.90
	26.9		2.3		0.12		48.3		2.6		0.90
	21.3		2.0		0.12		42.4		2.6		0.90
48.3	42.4	2.6	2.6	64	0.18	33.7	2.6	0.90			
	33.7		2.6		0.18	108.0	3.6	3.6	0.90		
	26.9		2.3		0.18	101.6	3.6	3.6	0.90		
	21.3		2.0		0.18	88.9	3.2	3.2	0.90		
60.3	48.3	2.9	2.6	76	0.30	76.1	2.9	0.90			
	42.4		2.6		0.30	60.3	2.9	0.90			
	33.7		2.6		0.30	48.3	2.6	0.90			
	26.9		2.3		0.30	42.4	2.6	0.90			
70.0	21.3	2.9	2.0	76	0.30	33.7	2.6	0.90			
	60.3		2.9		0.41	114.3	3.6	3.6	1.50		
	48.3		2.6		0.41	108.0	3.6	3.6	1.50		
	42.4		2.6		0.41	88.9	3.2	3.2	1.50		
76.1	33.7	2.9	2.6	89	0.41	76.1	2.9	1.50			
	60.3		2.9		0.47	70.0	2.9	1.50			
	48.3		2.6		0.47	60.3	2.9	1.50			
	42.4		2.6		0.47	114.3	3.6	3.6	1.70		
88.9	33.7	3.2	2.6	89	0.47	108.0	3.6	1.70			
	26.9		2.3		0.47	101.6	3.6	3.6	1.70		
	21.3		2.0		0.47	88.9	3.2	3.2	1.70		
	76.1		2.9		0.56	76.1	2.9	1.70			
	70.0		2.9		0.56	60.3	2.9	1.70			
101.6	60.3	3.6	2.9	100	0.56	139.7	4.0	2.30			
	48.3		2.6		0.56	133.0	4.0	2.30			
	42.4		2.6		0.56	114.3	3.6	2.30			
	33.7		2.6		0.56	108.0	3.6	2.30			
	26.9		2.3		0.56	88.9	3.2	2.30			
	88.9		3.2		3.2	0.88	76.1	2.9	2.30		
159.0	76.1	4.5	2.9	140	0.88	60.3	2.9	2.30			
	60.3		2.9		0.88						
	48.3		2.6		0.88						
	42.4		2.6		0.88						

Assotherm srl - Via Fratelli Calvi, 7 - 24060 Casazza (BG) Italy
 Tel +39 035813182 - Fax +39 035816892 - E-mail info@assotherm.com

FONDELLI

DISHED ENDS

EN 10253-1

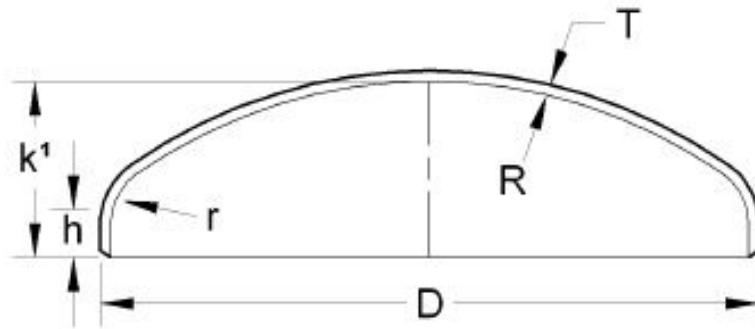

$$r = 0.1D$$

$$R = D$$

Dimensioni in mm.

D	T	h	K1	TOLL. K 1	Kg.
21.3	2.0	-	-	± 4	0.02
26.9	2.3	-	-		0.02
33.7	2.6	4	11		0.03
38.0	2.6	4	11		0.04
42.4	2.8	4	11		0.04
44.5	2.8	4	11		0.05
48.3	2.8	4	11.5		0.06
54.0	2.8	4	12.5		0.07
57.0	2.9	4	13		0.09
60.3	2.9	6	16.5		0.12
70.0	2.9	6	17.5		0.16
76.1	2.9	6	18.5		0.21
88.9	3.2	8	23		0.28
101.6	3.6	8	24.5		0.36
108.0	3.6	8	25.5		0.39
114.3	3.6	8	26		0.42
133.0	4.0	10	32	± 7	0.56
139.7	4.0	12	35.5		0.62
159.0	4.5	15	43		1.11
168.3	4.5	15	44.5		1.23
193.7	5.6	20	56		1.89
219.1	6.3	30	68.5		2.21
244.5	6.3	30	75		3.90
273.0	6.3	40	90		5.40
323.9	7.1	40	99		7.30
355.6	8.0	40	106		9.80
406.4	8.8	50	125		16.00

Assotherm srl - Via Fratelli Calvi, 7 - 24060 Casazza (BG) Italy
 Tel +39 035813182 - Fax +39 035816892 - E-mail info@assotherm.com