

GIUNTO IN GOMMA ANTIVIBRANTE FLANGIATO PN10/16

FLANGED RUBBER FLEXIBLE JOINT PN10/16

APPLICAZIONE:

Fornitura e distribuzione acqua ed aria compressa.

APPLICATION:

Water and compressed air supply and distribution.

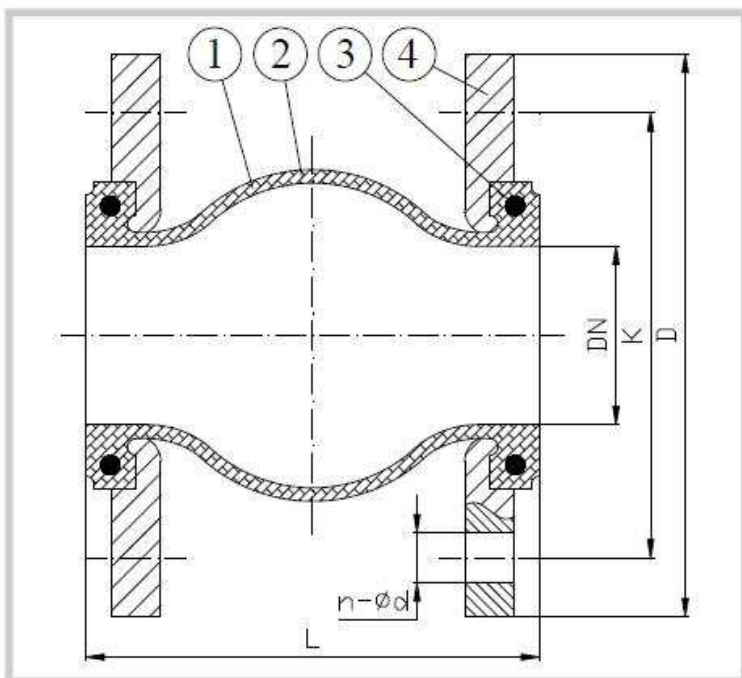
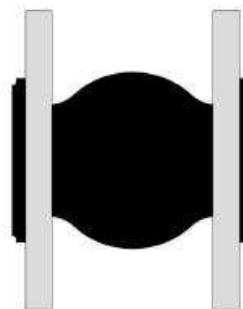

FLANGE: EN 1092-1
TEMP. ESERCIZIO: Max. +80°C
PRESSIONE DI ESERC.: DN32-300 16bar
DN350-600 10bar
DN700-800 6bar

FLANGES: EN 1092-1
WORKING TEMP.: Max. +80°C
WORKING PRESSURE: DN32-300 16bar
DN350-600 10bar
DN700-800 6bar

DENOMINAZIONE PART	MATERIALI MATERIALS
1 CORPO BODY	EPDM EPDM
2 RINFORZO REINFORCE	NYLON NYLON
3 FILO DI RINFORZO WIRE	ACCIAIO STEEL
4 FLANGIA GIREVOLE FLOATING FLANGE	ACCIAIO ZINCATO GALVANIZED STEEL

Dim Inch	DN	K		D		n-ød		L	Movimenti assiali Axial displacement		Movimento Laterale Lateral displacement	Angolo di inclinazione Angle of deflection	W (kg)
		PN10	PN16	PN10	PN16	PN10	PN16		Compressione Compression	Estensione Extension			
1"1/4	32	100	100	140	140	4-18	4-18	95	9	6	9	15°	2.3
1"1/2	40	110	110	150	150	4-18	4-18	95	10	6	9	15°	2.5
2"	50	125	125	165	165	4-18	4-18	105	10	7	10	15°	3.5
2"1/2	65	145	145	185	185	4-18	4-18	115	13	7	12	15°	5
3"	80	160	160	200	200	8-18	8-18	130	15	8	12	15°	6
4"	100	180	180	220	220	8-18	8-18	135	19	10	13	15°	7
5"	125	210	210	250	250	8-18	8-18	170	19	12	13	15°	9
6"	150	240	240	285	285	8-22	8-22	180	20	12	14	15°	12
8"	200	295	295	340	340	8-22	12-22	205	25	16	22	15°	16
10"	250	350	355	395	405	12-22	12-26	245	25	16	22	15°	26
12"	300	400	410	445	460	12-22	12-26	260	25	16	22	15°	30
14"	350	460	470	505	520	16-22	16-26	260	25	16	22	15°	39
16"	400	515	525	565	580	16-26	16-30	260	25	16	22	15°	50
18"	450	565	585	615	640	20-26	20-30	260	25	16	22	15°	55
20"	500	620	650	670	715	20-26	20-33	260	25	16	22	15°	66
24"	600	725	770	780	840	20-30	20-36	260	25	16	22	15°	87
28"	700	840	840	895	910	24-31	24-37	260	25	16	22	10°	110
32"	800	950	950	1015	1025	24-34	24-41	260	25	16	22	10°	140