

VALVOLA DI RITEGNO A PALLA FLANGIATA PN10/16

FLANGED BALL CHECK VALVE PN10/16

APPLICAZIONE:

Sistemi di pompaggio per acqua, liquidi viscosi, densi ed aggressivi.

APPLICATION:

Pumping station for clean water or viscous fluids.

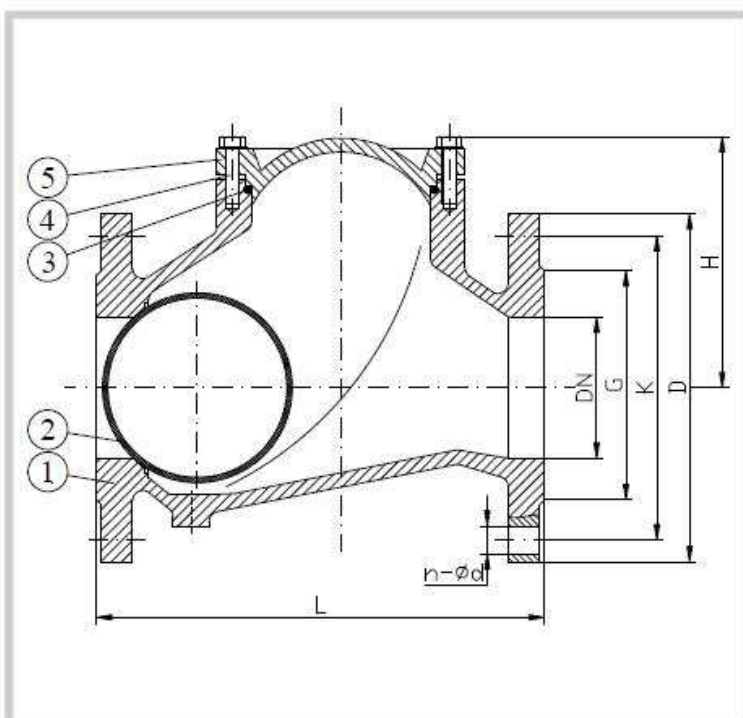

NORMA PROGETTO: EN 1074-3
SCARTAMENTO: EN 558 Serie 48
FLANGE: EN 1092-2
COLLAUDI: EN 12266-1
TEMP. ESERCIZIO: Max. +70°C
CONTROPRESSIONE: Min. 0,3/0,5 bar

DESIGN STANDARD: EN 1074-3
FACE TO FACE: EN 558 Serie 48
FLANGES: EN 1092-2
TESTS: EN 12266-1
WORKING TEMP.: Max. +70°C
BACKPRESSURE: Min. 0,3/0,5 bar

DENOMINAZIONE PART MATERIALI MATERIALS

DENOMINAZIONE PART	MATERIALI MATERIALS
1 CORPO BODY	EN-GJS 400-15 EN-GJS 400-15
2 PALLA BALL	METALLO+NBR (DN50-400) POLIURETANO (DN500) METAL+NBR (DN50-400) POLYURETHANE (DN500)
3 COPERCHIO BONNET	EN-GJS 400-15 EN-GJS 400-15
4 VITE BOLT	ACCIAIO INOX A2 STAINLESS STEEL A2
5 GUARNIZIONE GASKET	NBR NBR

DN	G	K		D		n-ød		L	H	W (kg)
		PN10	PN16	PN10	PN16	PN10	PN16			
50	99	125	125	165	165	4-19	4-19	200	106	7.7
65	118	145	145	185	185	4-19	4-19	240	129	11.2
80	132	160	160	200	200	8*-19	8-19	260	146	15.4
100	156	180	180	220	220	8-19	8-19	300	194	22
125	184	210	210	250	250	8-19	8-19	350	207	33
150	211	240	240	285	285	8-23	8-23	400	240	45
200	266	295	295	340	340	8-23	12-23	500	322	90
250	319	350	355	395	405	12-23	12-28	600	388	163
300	370	400	410	445	460	12-23	12-28	700	458	230
350	429	460	470	505	520	16-23	16-28	800	580	290
400	480	515	525	565	580	16-28	16-31	900	730	450
500	**	620	650	670	715	20-28	20-34	1100	900	580

RIVESTIMENTO ESTERNO/INTERNO: Polvere epossidica di colore blu RAL 5017 con spessore 200µm.

SURFACE PROTECTION: FBE coating process with epoxy resin powder of blue colour RAL 5017 and thickness of 200µm.

*Disponibile anche con 4 fori

**PN10 G=582mm PN16 G=609mm

*Available also with 4 holes

**PN10 G=582mm PN16 G=609mm